

CB-V▲C Protect

CVAC Protect Fuse Catalogue – CBP-EVL Series





CBP-EVL Series Overview

Key Fuse Highlights:

- Application: EV battery packs, energy storage, power and charging systems
- Voltage: **250VDC**
- Current: **80–500A**
- Construction: Compact, low I^2t , high performance

Key Features

1. **Low I^2t for fast response**, minimal energy let-through, and high breaking capacity
2. **Optimized for DC systems** — ideal for EV battery protection and energy storage
3. **Reliable arc suppression** ensures safe interruption in inductive circuits
4. **EV-grade protection** for sensitive components and wiring systems
5. **Compact, space-saving design** allows easy integration into tight layouts
6. **High-strength ceramic body** offers excellent thermal resistance, mechanical durability, and insulation
7. **Precision fuse element** engineered for consistent and accurate performance
8. **Advanced welding process** minimizes temperature rise and power loss

CBP-EVL Series 250Vdc 80-500A

Specification Matrix

Current (A)	Part Number	Body Size	Pre-Arcing I ² t (A ² s)	Total I ² t (A ² s)	Power Loss (W)
80	CBP-EVL080A	A	400	1800	9
100	CBP-EVL100A	A	700	3000	12
125	CBP-EVL125A	A	1100	4800	15
160	CBP-EVL160A	A	1900	8500	18
200	CBP-EVL200A	A	2500	11000	22
250	CBP-EVL250A	A	3500	17500	26
315	CBP-EVL315A	A	6000	27000	30
350	CBP-EVL350A	A	10000	45000	35
400	CBP-EVL400A	A	14000	63200	40
450	CBP-EVL450A	A	24000	99800	45
500	CBP-EVL500A	A	26000	120000	50

Dimensions

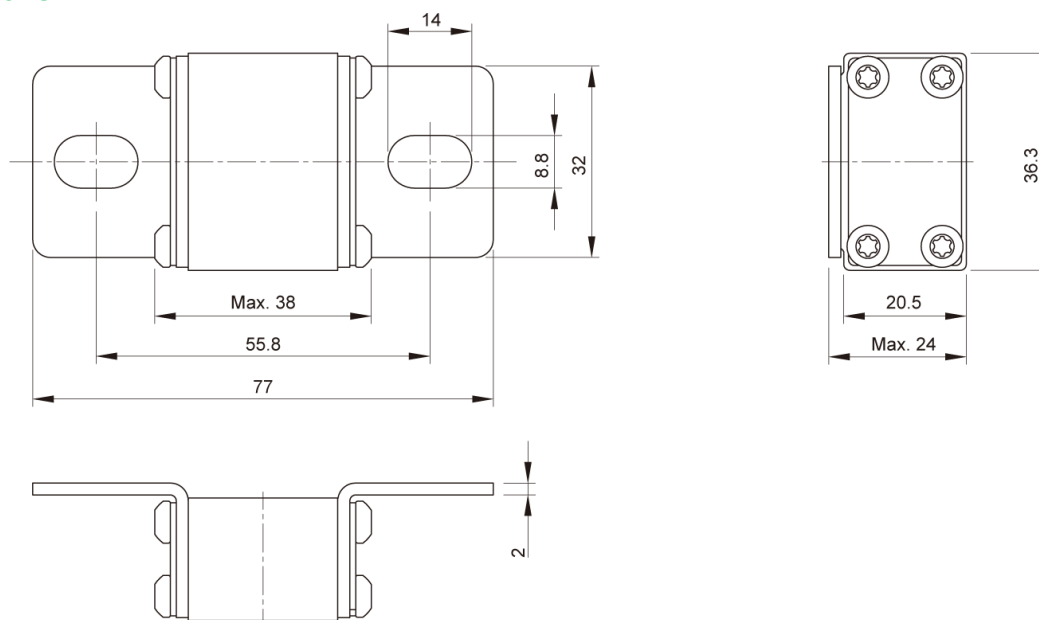

EVL (Unit: mm)

Contact Us



35 Viking Lane, Toronto, ON, M9B 0A2 (Canada)

info@componentbasics.com

www.componentbasics.com